

NMR Facility Layout, September 2016

<http://sites.psu.edu/nmrlaboratorypsu/>

13 NMR Laboratory D
High Field Liquid State NMR

15 State NMR



AV3-850



AV3-600



AV3-500

9 NMR Laboratory C
Liquid State NMR



DRX-400



CDPX-300



AMX-300



DPX-300

7 NMR Laboratory B
Solid State NMR



SS-500

6 NMR Laboratory A



SS-300



HD-500

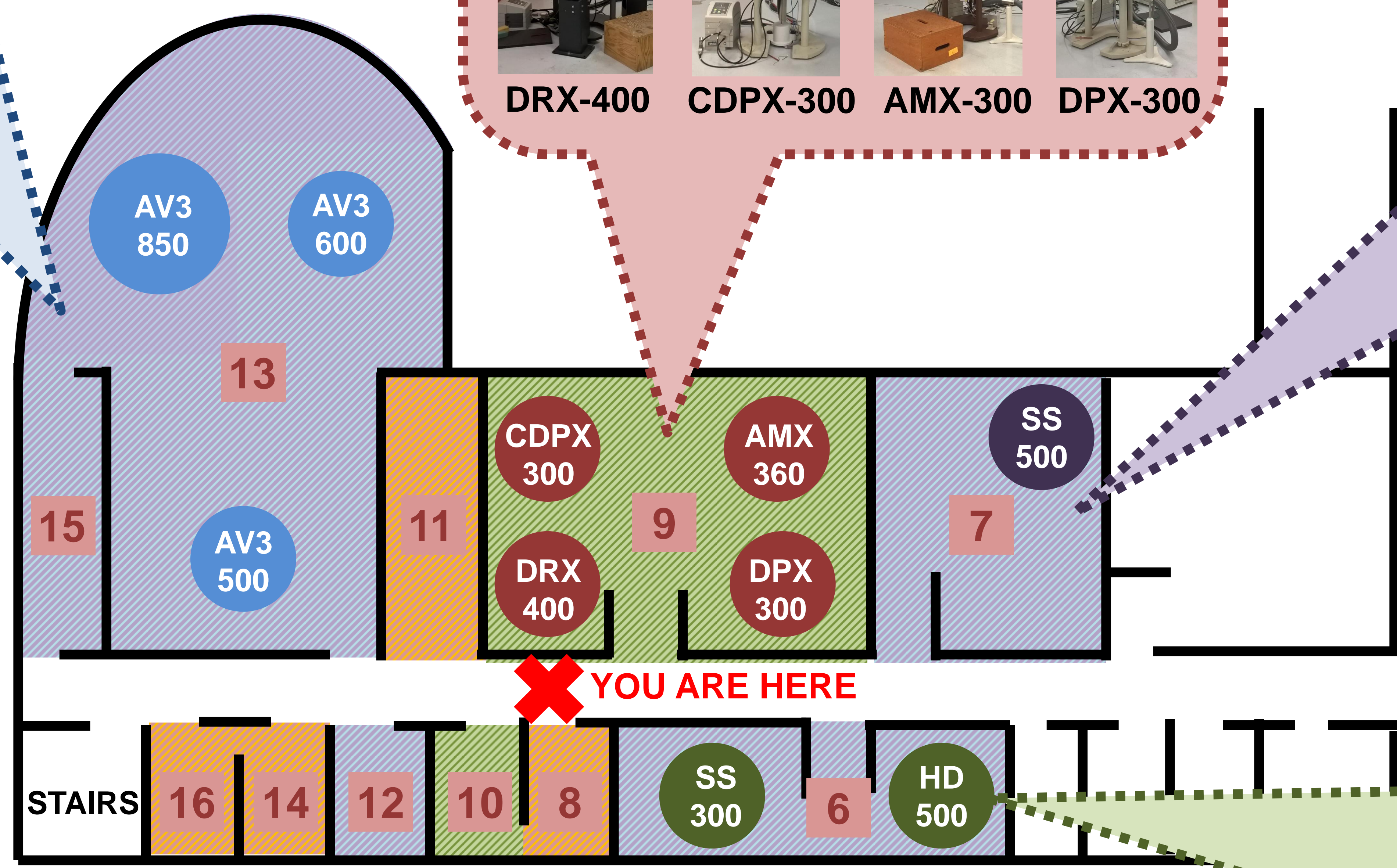

LEGEND

- Open 9-5 pm, weekdays. For after hours access, key required.
- NMR Staff access only.
- Open 24/7

- 8** NMR Office
- 10** NMR Computer Lab - station for data analysis and transfer
- 11** NMR Facility Utility Area
- 12** NMR Prep Lab - lab space for preparing liquid state samples
- 14** NMR Office
- 16** NMR Solid State Prep Room/NMR Storage Room